



Care Guide

Congratulations on your new and beautiful space. Just like anything, it will require maintenance, and with time, questions may arise. Just like you'd expect a user manual with your brand new purchase, we're offering you the same. This care guide is designed to help you better understand the answers to common questions. All information below is considered normal and routine. For anything beyond this, Kitchens by Bruce is happy to consult with you. The following information has been adapted from our cabinetry manufacturers' websites, resources, and care guides, as well as our own professional recommendation and experience.

Table of Contents:

.....2: *Cabinetry*
.....4: *Drawers and Hinges*
.....7: *Countertop Care*
.....8-11: *Other Maintenance*
.....12-14: *Hinge Adjustment Resources*

-Cabinetry-

How should I clean my cabinets?

- *No wood or finish is completely moisture proof. Not even highly durable and moisture-resistant fine furniture finish. To maintain the look and style that is uniquely yours, follow these everyday cabinet care and cleaning dos and don'ts.*
- *DO: Wipe up spills and watermarks as they occur, including splashes and drips.*
- *DO: Clean cabinets as needed with a lint-free cloth, dampened with only warm water.*
- *DO: Use a very mild soap, and only warm water, if needed.*
- *DO: Remove grease using a 50/50 mix of vinegar and water.*
- *DO: Dry immediately with a lint-free cloth, after wiping and cleaning an area.*
- *DON'T: Use scouring pads, harsh chemicals, powdered cleansers or any ammonia-based products to clean cabinetry.*
- *DON'T: Wipe your cabinets with a dishcloth as it can contain remnants of grease and other contaminants.*
- *DON'T: Drape damp or wet towels over a door or drawer front, as constant moisture will cause permanent water damage over time.*

What does it mean if...

- I see hair-line breaks and/or seam lines in the painted finish at my cabinetry's panel, stile and rail joints?
 - *Opaque finishes are uniquely different from stain finishes. Changes in climate conditions cause wood products to expand and contract. Wood's expansion and contraction will result in finish breaks and/or seam lines at my cabinetry's panel, stile and rail joints. Opaque finishes are not recommended for use in high humidity environments. Additionally, opaque finishes on Oak will not completely fill open grain areas. An opaque finish on rustic wood will obscure all but the most pronounced rustic characteristics. The items listed above are normal characteristics of opaque wood finishes and will not be considered as reasons for product replacement.*
- I see doors that don't perfectly line up with each other anymore, and gaps between doors aren't totally uniform?
 - *Wood's natural response to changes in humidity is much more dramatic than the average person realizes. The degree of changes can range over a quarter of an inch from summer to winter months depending on many factors. A cabinet door panel is likely to shrink in low humidity and expand in excess humidity. KBB's first full door adjustment is complementary*

upon cabinetry installation and finishing touches. Further door movement is unavoidable, and ultimately is a losing battle. However, most of these changes happen in the first complete climate heating and cooling cycle as the cabinetry acclimates to your specific home environment. While your cabinetry is being created, climate controlled air in the factory is monitored between 40 to 45% relative humidity during the complete manufacturing process. However, cabinetry warranties DO NOT apply if our cabinetry is exposed to extremes in temperature or humidity in your home. Excessive variations in humidity will cause noticeable changes to your cabinetry, including but not limited to:

- *White lining of panels (raw wood showing at a joint on a stained door panel)*
- *Excessive gaps or overlapping of doors*
- *Warping*
- *Open joints*
- *Paint cracking or lifting*

[How can I maintain proper humidity?](#)

- *Monitor and maintain your humidity — reasonably accurate digital thermometer-hygrometer units are available from general goods retailers and hardware stores. Maintain humidity levels between 30% to 45% at all times —install a whole-house humidifier on the furnace is best for dry climates, Running a portable humidifier in key areas also helps. For very humid climates, air conditioning helps to dry down the air to the desired range. Don't over do it — significant condensation on windows is a sign that humidity levels are too high for outside temperature conditions in cold weather. Watch wood response — it's important to understand that finished wood responds to humidity over several weeks or as long as two months. It takes time before wood returns to normal after any correction to the environment.*

-Drawers and Hinges-

My drawer looks funny. Why is it crooked compared to the others?

- *Many times, you're anxious to get your plates organized in that new, deep drawer base. Often, when a lot of weight is applied (don't panic, the drawer glides are rated for it) in a drawer, it reacts slightly differently than when it is empty. Additionally, sometimes you may pull it open on an angle, rather than straight. The rear of the drawer glides are designed with a built-in safety feature. Imagine if they were anchored to the back of the cabinet, and someone accidentally ran into the drawer while it was open. You can imagine the trouble. The back of the drawer is designed to slide, and self-align, to prevent damage or bending of the glides. See the below diagram for an explanation of how to align your drawer if it somehow becomes slightly mis-aligned. All other adjustments (height, side-to-side) should rarely be necessary, and have already been done by KBB.*

Self-Aligning Feature

Drawer alignment is easy. Double-captive rollers ensure proper drawer front alignment. After installation is complete, just reinsert drawers and close firmly. The drawers will self-align to bring all fronts into the proper position.

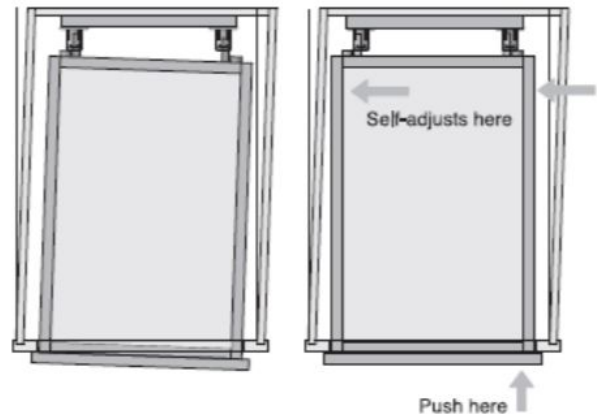

I need to remove my drawer. How do I do so?

- **All BLUM drawer glides have orange “levers” just under and behind the drawer front, and come standard with Woodland Cabinetry. Simply squeeze both levers as pictured below, and gently extend the drawer past full open extension to remove it. Squeezing the levers is not necessary to replace the drawer. Just align the glides in the drawer grooves, and close the drawer all the way, with a good push. You should hear a healthy “click” if the drawer has properly re-seated on the glides.**

Drawer insertion

1. Place drawer on runners and close. Locking devices will automatically connect to runners.

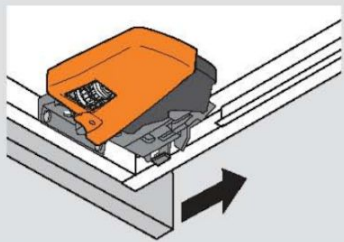

Drawer removal

1. Squeeze orange handles on locking devices
2. Pull drawer straight out and up

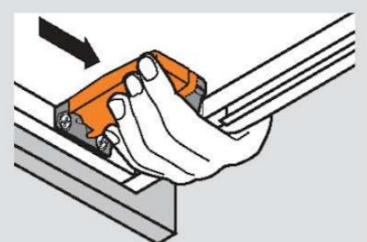

- **All GRASS drawer glides have green levers, and come standard with Marsh Cabinetry. See below diagram for instruction on drawer removal and replacement.**

ELITE PLUS Height Adjustment and Drawer Removal/Insertion Instructions

REMOVAL

- 1 Pull out drawer to extended position
- 2 Squeeze the front locking device levers and lift drawer from the slide

ADJUSTMENT

A Tool-less height adjustment 2.5mm (3/32") by sliding the adjustment plate tab

INSERTION

- 3 Place drawer on extended slide
- 4 Push in until drawer engages audibly

G*GRASS® www.grassusa.com #000000

My door looks like it moved and is slightly mis-aligned compared to the others. Can I adjust the hinges, somehow?

- ***BLUM compact hinges (with soft-close technology) are standard on full-overlay cabinetry from Woodland. BLUM clip-on hinges (with soft-close technology) are standard on frameless (full-access) cabinetry from Woodland. If you would like to tackle small door hinge adjustments, or remove doors on your own, please use the attached diagrams for Woodland Cabinetry's hinges:***
 - *WOODLAND_COMPACT (p.10), WOODLAND_CLIP (p.9)*
- ***GRASS TEC soft-close hinges are standard on cabinetry from Marsh. Please use the attached diagrams for Marsh Cabinetry's hinges:***
 - *MARSH_GRASSTEC (p.11)*
- ***Here are rare exceptions, where KBB intervention may be necessary:***
 - *Lazy Susan cabinets have complex hinge systems, and are more difficult to adjust. If one of these doors looks to be badly out of alignment (beyond the normal movement discussed previously), please consult KBB.*
 - *A hinge screw has been broken, or ripped out, or the hinge is defective, faulty, or not closing smoothly and properly.*

Some doors swing open further than others.. Why?

- ***110 degrees is a standard hinge swing. Hinge restrictors reduce this degree of opening to 86 degrees. You will see that KBB will install hinge restrictors where applicable in door hinges (cabinet door-to-door, door-to-frame, or door-to-wall contact). These restrictors make the door feel like it stops short. This is protecting your cabinet for years to come. Some doors can maintain their full 110 degree swing, to maximize usability, where applicable.***
 - *Mild hinge restriction may be used to reduce the door opening where roll-out trays are present. This allows only some angle restriction, but not too much, as the roll-out trays would no longer open.*

-Countertop Care-

How should I clean my countertops on a daily basis?

- *Soap and water will be sufficient for daily cleaning. Avoid using abrasive cleaners.*

Can I damage my countertops?

- *Avoid placing hot pans on quartz, since it can scorch the man-made resin.*
- *Pots/pans can leave smudges on light-colored quartz. Attempt to use soap and water first. In general, dark-colored smears can be cleared. Goof-Off or, often, a magic eraser are recommended for tougher spots. Creams, lotions, coffee, wine, and other acidic items have the potential to stain your countertop as well.*
- *If a polished finish on quartz, granite, or other stone becomes dull or reduced, it may mean it has been abraded. Acidic substances can mar your new surface. Signs of this may be a light-colored patch, as well, where finish has worn through to stone. This is rare.*

Is there anything I need to do to seal my countertops?

- *If you have quartz, the answer is no. If you have granite, depending upon your use of the countertops, most good sealers are rated for a span of 5-7 years. Granite is naturally porous, and more susceptible to staining. Due to quartz's man-made fabrication, it is not. Our personal recommendation is that you touch up your countertops with a sealer yearly, as good general maintenance practice. Dupont, Dry Treat, or Stonetech BulletProof cleaner/sealers are recommended.*

-Other Maintenance-

The grout line where my tile meets another surface has cracked. Is this normal?

- ***If you look around ANY house, chances are you'll see caulk. Caulk is a universal, highly-expandable product for filling gaps. The most common areas where grout caulk will crack is along your countertop, or where a tile surround meets a tub. Even the best caulk will eventually crack. Despite all efforts to use grout-caulk where tile meets your countertop, it will continue to crack as well. Here's how we explain it: your countertop is anchored to cabinetry. Your cabinetry is wood, sitting on top of a highly active wood substrate. Wood expands and contracts (although fractions of an inch, these movements can compound one another), and so does your countertop along with it. Your backsplash is anchored to your wall. This may move marginally, or not at all. Either way, the tile backsplash is anchored to a different surface. As a result, the joint between the tile and countertop is the weakest link, and cracks. This is very normal.***
 - ***Just like a car, a tool, or your lawn, your kitchen needs to be maintained. The countertop-backsplash joint is one example. We usually leave our customers with a grout-matched caulk, but if for some reason you can't find it, just call KBB, and we'd be happy to order you a tube of color-matched caulk for your specific grout. All you need is a simple scraping tool, caulk gun, a wet rag, and 10-15 minutes of your time.***
 - ***See the below link for a generic video tutorial on how to re-caulk your grout. Please read all instructions on the caulk, as well. Note that (even though our caulk is manufactured through Mapei) the application process is the same.***
 - **<http://www.colorfastind.com/tileandgroutcaulk.htm>**





Keracaulk® S / U

Premium, Sanded and Unsanded Siliconized Acrylic Caulks



DESCRIPTION

Keracaulk S (sanded) and *Keracaulk U* (unsanded) are premium-grade, easy-to-use, easy-to-clean siliconized acrylic caulks formulated to match all of MAPEI's grout colors.

FEATURES AND BENEFITS

- Water cleanup while fresh
- Paintable
- BioBlock® technology for mold and mildew resistance
- Packaged in gun-grade tubes for easy application
- VOC-compliant

INDUSTRY STANDARDS AND APPROVALS

- ASTM: Meets C834 for low-movement sealant

<u>LEED v3 Points Contribution</u>	<u>LEED Points</u>
MR Credit 5, Regional Materials*	Up to 2 points
IEQ Credit 4.1, Low-Emitting Materials – Adhesives & Sealants	1 point
IEQ Credit 4.3, Low-Emitting Materials – Flooring Systems	1 point

**Using this product may help contribute to LEED certification of projects in the categories shown above. Points are awarded based on contributions of all project materials.*

WHERE TO USE

- For gaps up to 1/4" (6 mm)
- As a flexible barrier/filler between horizontal and vertical surfaces to prevent cracked tile due to expansion
- For filling joints where tile abuts dissimilar surfaces
- For caulking around sinks, tubs, showers, countertops and ceramic tile floors

- For interior use only
- For restoring cracked or worn grout joints

LIMITATIONS

- Do not install over substrates containing asbestos.
- The application temperature range is 50°F to 90°F (10°C to 32°C).
- Apply only to clean, dry surfaces.
- For both *Keracaulk S* and *Keracaulk U*, joints should not exceed 1/4" (6 mm) in width.
- Do not use for exterior projects or applications subject to constant water immersion.
- Do not use in areas where joints will be subject to heavy abrasion or wear.
- Allow new concrete to cure for 30 days before caulking.
- Although *Keracaulk S* and *Keracaulk U* are color-matched to MAPEI's grouts, expect a slight variation in color due to the difference in composition between materials.
- For applications beyond 1/4" (6 mm) in depth, the caulking depth must be controlled by a closed-cell backer rod.
- To ensure product effectiveness, do not apply *Keracaulk S* or *Keracaulk U* thinly, as with a paint.
- *Keracaulk S* and *Keracaulk U* may stain porous materials. Test on a separate area before final application.
- Refer to the project's ASTM requirements before commercial use of *Keracaulk S* and *Keracaulk U*.

SURFACE PREPARATION

- Surfaces must be structurally sound, stable, clean and free from dust, oil, grease, paint, gypsum patch, flooring adhesive, tar, wax, sealers, curing



compounds, form release agents, laitance, loose particles and foreign substances that could reduce or impair adhesion.

- Remove all traces of paint, loose particles, residue and cement particles by mechanical means.
- Remove mildew by scrubbing with a mixture of 4 U.S. oz. (118 mL) of trisodium phosphate (TSP), 1 U.S. qt. (946 mL) of liquid bleach and 3 U.S. qts. (2.84 L) of warm water. Protect eyes and hands by wearing goggles and water/chemical-resistant gloves. Thoroughly rinse and allow surface to dry completely before caulking and painting.
- Vacuum out joints and wipe them clean with a damp rag.

Consult MAPEI's Technical Services Department for installation recommendations regarding substrates and conditions not listed.

PRODUCT APPLICATION

Read all installation instructions thoroughly before installation.

1. Tile should be firmly set before caulking. Typically, this is 24 to 48 hours after tile installation.
2. Caulking may be done either before or after grouting.
3. For a clean, straight and neat caulk joint, mask both sides of the joint with masking tape.
4. *Keracaulk S* and *Keracaulk U* come ready to use. Apply with a caulking gun. Do not open cartridges until preparatory work has been completed.
5. Cut the nozzle tip to the desired bead size at a 45-degree angle.
6. Completely fill joints with sealant and smooth over with a wet, gloved finger.
7. Excess caulk should be removed with a damp cloth before the caulk skins over.
8. Immediately wash hands and tools with warm water and soap.

PROTECTION

1. Allow 24 hours of drying time before painting.
2. Protect from water exposure until fully cured for at least 72 hours.

Note: Large beads of caulk and cool, humid conditions will require a longer drying time.

Shelf Life and Product Characteristics*

at 73°F (23°C) and 50% relative humidity

Drying time	24 to 48 hours
Shelf life	1 year when stored in original, unopened packaging
VOCs (Rule #1168 of California's SCAQMD)	< 25 g per L
Colors	Available in MAPEI's palette of 40 colors (plus Clear for <i>Keracaulk U</i> only), organized into 5 color collections. Refer to MAPEI's grout/caulk color chart. Sample color chips are available upon request.

* Cold temperature or high humidity may alter these properties.

Packaging

Size
<i>Keracaulk S</i> : 10.5 U.S. oz. (311 mL) tube
<i>Keracaulk U</i> : 10.5 U.S. oz. (311 mL) tube

Approximate Coverage** per 10.5 U.S. oz. (311 mL)

Joint Size	Coverage
1/16" (1,5 mm)	48 to 50 lin. ft. (14,6 to 15,2 m)
1/8" (3 mm)	24 to 25 lin. ft. (7,32 to 7,62 m)
3/16" (4,5 mm)	15 to 17 lin. ft. (4,57 to 5,18 m)
1/4" (6 mm)	11 to 13 lin. ft. (3,35 to 3,96 m)

** Coverages shown are for estimating purposes only. Actual jobsite coverages may vary depending on the joint size and application procedures.

Refer to the SDS for specific data related to health and safety as well as product handling.

LEGAL NOTICE

The contents of this Technical Data Sheet ("TDS") may be copied into another project-related document, but the resulting document shall not supplement or replace requirements per the TDS in effect at the time of the MAPEI product installation. For the most up-to-date TDS and warranty information, please visit our website at

www.mapei.com. **ANY ALTERATIONS TO THE WORDING OR REQUIREMENTS CONTAINED IN OR DERIVED FROM THIS TDS SHALL VOID ALL RELATED MAPEI WARRANTIES.**

Before using, the user must determine the suitability of our products for the intended use, and the user alone assumes all risks and liability. **ANY CLAIM SHALL BE DEEMED WAIVED UNLESS MADE IN WRITING TO US WITHIN FIFTEEN (15) DAYS FROM DATE IT WAS, OR REASONABLY SHOULD HAVE BEEN, DISCOVERED.**

We proudly support the following industry organizations:



TTMAC ACTTM



MAPEI Headquarters of North America
1144 East Newport Center Drive
Deerfield Beach, Florida 33442
1-888-US-MAPEI (1-888-876-2734) /
(954) 246-8888

Technical Services
1-800-992-6273 (U.S. and Puerto Rico)
1-800-361-9309 (Canada)

Customer Service
1-800-42-MAPEI (1-800-426-2734)

Services in Mexico
0-1-800-MX-MAPEI (0-1-800-696-2734)

Edition Date: September 6, 2017
PR: 4127 MKT: 17-2241

For the most current BEST-BACKED™ product data and warranty information, visit www.mapei.com.

All Rights Reserved. Printed in the USA. © 2017 MAPEI Corporation.

What do I need to know about my new wood floors?

We hope you will enjoy the floor we've provided you with for years to come. With care, and understanding, wood floors can look fantastic for a lifetime. Please take time to read the following recommendations, adapted from BHI & Flooring, LLC.

- Polyurethanes (and water-based finishes) take 6-10 days minimum to fully cure, so please wait 2 weeks before placing any area rugs down. Full curing of most polyurethanes can take months, so it is wise to be careful for at least this period of time.
- Polyurethane should be dry enough to carefully walk on within 24hrs. The polyurethane will be soft and easy to scratch for the first 2-3 days.
- Furniture, as long as it is picked-up and placed (not dragged), may be replaced as soon as the floor is dry enough to walk on; typically 24hrs after the application of the last coat. Apply felt to the legs of every single piece of furniture that will be in contact with the flooring surface to help prevent scratching.
- Maintenance of your polyurethane-coated hardwood flooring should include regular dust mopping - damp mopping only - do not wet mop. We suggest using only steam mops, or damp mopping using distilled white vinegar, or glass cleaners heavily diluted with water to clean your flooring.
- Periodic screening and recoating of your flooring will help to prevent the need for future sanding and/or complete refinishing of your flooring. This process removes most surface scratching, adds a new coat(s) of polyurethane, which then renews the life, the finished appearance, and durability of your hardwood flooring.
- Preventative maintenance is critical, to ensure that your flooring lasts you a lifetime; each subsequent sanding/refinishing of your hardwood flooring takes life away from the floorboards. Keep in mind that re-coating is also much more cost effective and less invasive than the full re-finishing process. (To screen and recoat, you would only lose access to the area being worked on for a maximum of 24 hours.) Everyone's flooring application and floor traffic patterns are different. Despite this, most high-trafficked areas will need attention every 5-10 years on average. Lesser used areas, such as bedrooms, may never need re-coating as long as they are properly maintained and cared for. It is important to keep sand and dirt off your floors, and to watch the sheen in high-traffic areas; the finish will develop wear in these areas over time. If you can re-coat before you've worn through the polyurethane, so that the surface of the wood is never exposed, you can save yourself a lot of frustration.

Appendix: WOODLAND_CLIP

Adjustments

Hinges



Three-Dimensional Adjustment

Side adjustment

Rotate front screw to increase or decrease door overlay (± 2 mm)

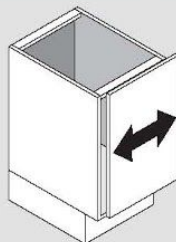
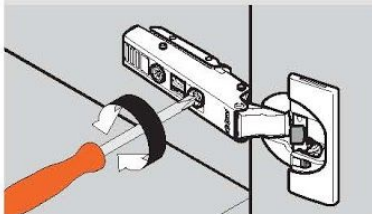

Height adjustment

Rotate cam screw on mounting plate to adjust door position (± 2 mm)

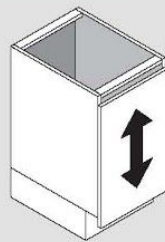
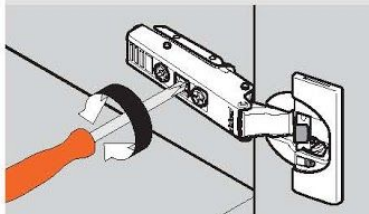

NOTE: On non-cam mounting plates, loosen screws, adjust door and retighten screws

Depth adjustment

Rotate rear spiral tech cam screw to adjust door gap (+3 mm, -2 mm)

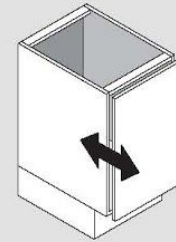
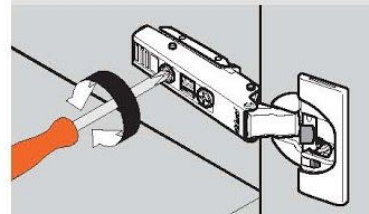

BLUMOTION Deactivation

Deactivation switch on hinge cup

For small or light doors, the BLUMOTION can be deactivated on one of the hinges

Door must be closed once for the deactivation to be complete. To reactivate, move switch back to original position.

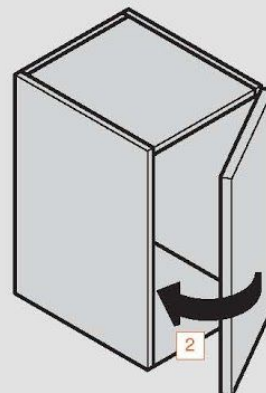
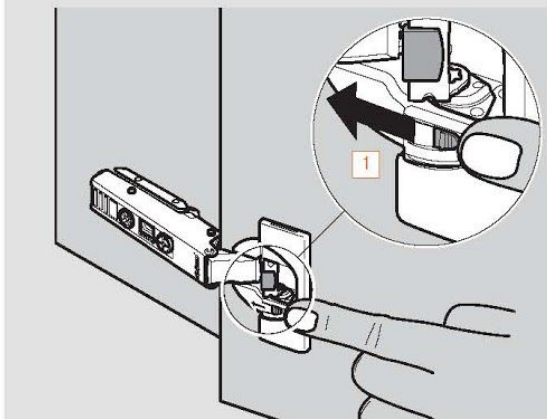

i Temperature information

CLIP top BLUMOTION is designed to be used at temperatures between 65° and 85° F. Lower or higher temperatures will not cause damage to the hinge, however they will affect the closing speed. Once the temperature returns to the suggested range the hinge will return to its optimal closing action.

Appendix: WOODLAND_COMPACT

Hinges



Adjustments

Three-dimensional adjustment

Side adjustment
 Rotate the front cam screw to increase or decrease door overlay ($\pm 1/16"$)

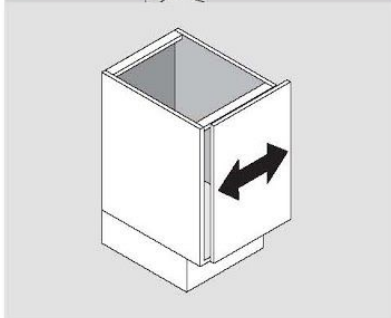
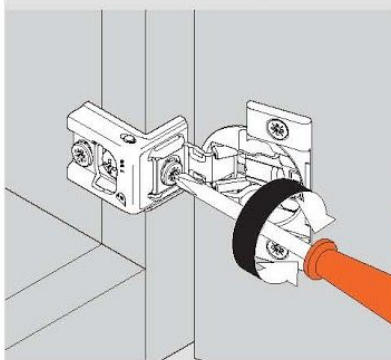

Height adjustment
 Loosen installation screws to adjust door position ($\pm 1/8"$), then retighten

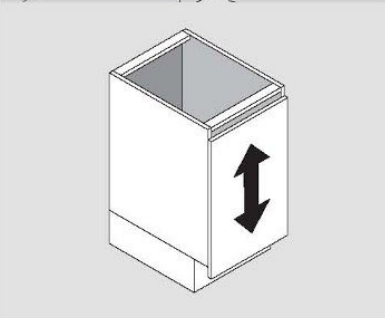
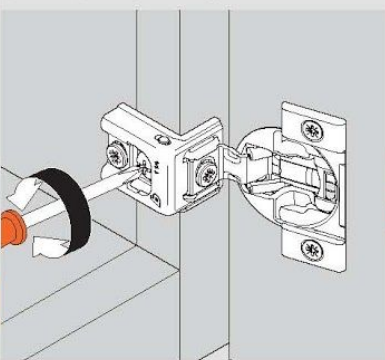

Depth adjustment
 Rotate the rear cam screw to adjust door gap ($+ 3/32"$, $- 1/32"$)

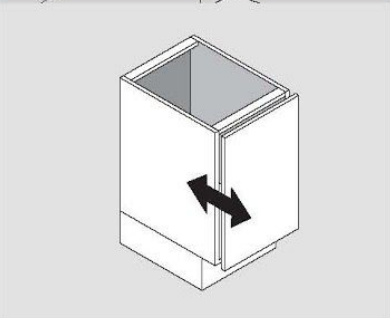
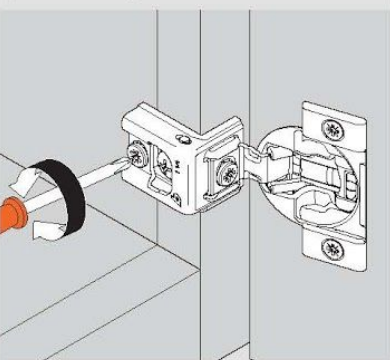

BLUMOTION Deactivation

Deactivation switch on the hinge cup

For small or light doors, the BLUMOTION can be deactivated on one of the hinges. COMPACT BLUMOTION comes in the activated position, marked with a "1". The deactivated position is marked with a "0".

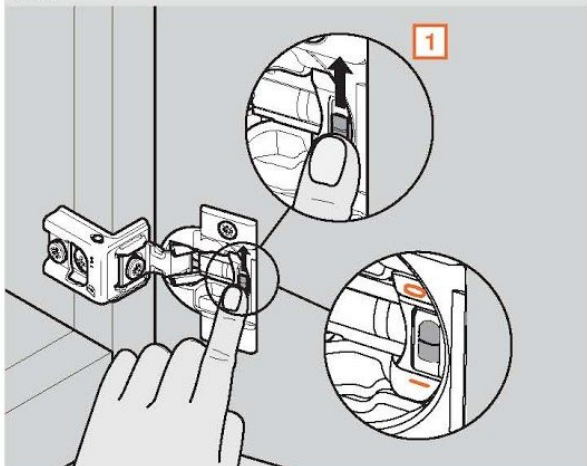

Door must be closed once for the deactivation to be complete. To reactivate, move switch back to the original position "1".

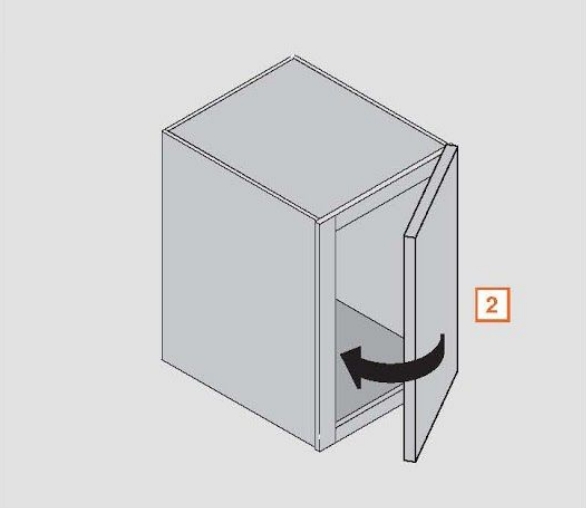

Appendix: MARSH_GRASSTEC



Technical Information

for TEC Hinges

Adjustments

TEC hinges offer a convenient three dimensional adjustment.

- 1 Side Adjustment
Rotate cam adjustment screw.
- 2 Height Adjustment
Loosen screw, align door, tighten screw.
- 3 Depth Adjustment
Rotate cam screw.

TEC Soft-close hinges offer an adjustable three tier closing mechanism.

- 4 Soft-close Tension - A Light, B Medium, and C Strong settings

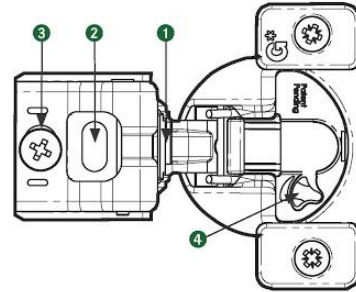

LIGHT

- A This is the "LIGHT" setting for the Soft-closing mechanism. Set here for light or small doors with very little closing pressure.



MEDIUM

- B This is the "MEDIUM" setting for the Soft-closing mechanism. Set here for average size doors with normal closing pressure.



STRONG

- C This is the "STRONG" setting for the Soft-closing mechanism. Set here for larger or heavier doors with a strong closing pressure. (Factory Setting)



Note: To reset the Soft-close damper, move the adjustment switch to 'STRONG', then to the desired position. Close the door and the Soft-close will be reset.